

Metrische Zahnscheiben für zylindrische Bohrung Metric timing belt pulleys for plain boring

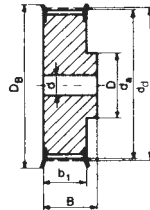

Ausf. Type 6F

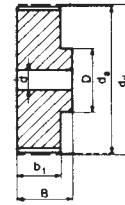

Ausf. Type 6

Type AT5 – Teilung Pitch 5 mm für Riemenbreite for belt width 10 mm

Bezeichnung Part No.	Anzahl der Zähne No. of teeth	Aus- führung Type	Material	d _d (mm)	d _a (mm)	D _B (mm)	b ₁ (mm)	B (mm)	D (mm)	Vor- bohrung Pilot bore d (mm)	Fertig- bohrung Finished bore d _{max} (mm)	Gewicht Weight (≈ kg)
21 AT5/12-2	12	6F	Al	19,01	17,85	23,0	15	21	10	—	6	0,016
21 AT5/14-2	14	6F	Al	22,29	21,05	25,0	15	21	13	—	8	0,019
21 AT5/15-2	15	6F	Al	23,88	22,65	28,0	15	21	16	6	10	0,021
21 AT5/16-2	16	6F	Al	25,47	24,20	32,0	15	21	18	6	11	0,025
21 AT5/18-2	18	6F	Al	28,65	27,40	32,0	15	21	19	6	12	0,031
21 AT5/19-2	19	6F	Al	30,25	29,00	36,0	15	21	22	6	12	0,036
21 AT5/20-2	20	6F	Al	31,83	30,60	36,0	15	21	23	6	14	0,038
21 AT5/22-2	22	6F	Al	35,12	33,85	38,0	15	21	24	6	15	0,046
21 AT5/24-2	24	6F	Al	38,21	37,00	42,0	15	21	26	6	15	0,054
21 AT5/25-2	25	6F	Al	39,80	38,60	44,0	15	21	26	6	15	0,058
21 AT5/26-2	26	6F	Al	41,47	40,20	44,0	15	21	26	6	16	0,062
21 AT5/27-2	27	6F	Al	42,98	41,80	48,0	15	21	30	8	18	0,064
21 AT5/28-2	28	6F	Al	44,62	43,35	48,0	15	21	32	8	18	0,071
21 AT5/30-2	30	6F	Al	47,76	46,55	51,0	15	21	34	8	18	0,075
21 AT5/32-2	32	6F	Al	50,94	49,70	54,0	15	21	38	8	22	0,088
21 AT5/36-2	36	6F	Al	57,31	56,05	63,0	15	21	38	8	22	0,114
21 AT5/40-2	40	6F	Al	63,66	62,45	66,0	15	21	40	8	23	0,138
21 AT5/42-2	42	6F	Al	66,87	65,60	71,0	15	21	40	8	24	0,180
21 AT5/44-0	44	6	Al	70,07	68,80	—	15	21	45	8	26	0,185
21 AT5/48-0	48	6	Al	76,42	75,15	—	15	21	50	8	28	0,200
21 AT5/60-0	60	6	Al	95,52	94,25	—	15	21	65	8	35	0,307

Type AT5 – Teilung Pitch 5 mm für Riemenbreite for belt width 16 mm

27 AT5/12-2	12	6F	Al	19,01	17,85	23,0	21	27	10	—	6	0,022
27 AT5/14-2	14	6F	Al	22,29	21,05	25,0	21	27	13	—	8	0,026
27 AT5/15-2	15	6F	Al	23,88	22,65	28,0	21	27	16	6	10	0,029
27 AT5/16-2	16	6F	Al	25,47	24,20	32,0	21	27	18	6	11	0,035
27 AT5/18-2	18	6F	Al	28,65	27,40	32,0	21	27	19	6	12	0,043
27 AT5/19-2	19	6F	Al	30,25	29,00	36,0	21	27	22	6	12	0,049
27 AT5/20-2	20	6F	Al	31,83	30,60	36,0	21	27	23	6	14	0,053
27 AT5/22-2	22	6F	Al	35,12	33,85	38,0	21	27	24	6	15	0,054
27 AT5/24-2	24	6F	Al	38,21	37,00	42,0	21	27	26	6	15	0,076
27 AT5/25-2	25	6F	Al	39,80	38,60	44,0	21	27	26	6	15	0,081
27 AT5/26-2	26	6F	Al	41,47	40,20	44,0	21	27	26	6	16	0,085
27 AT5/27-2	27	6F	Al	42,98	41,80	48,0	21	27	30	8	18	0,090
27 AT5/28-2	28	6F	Al	44,62	43,35	48,0	21	27	32	8	18	0,092
27 AT5/30-2	30	6F	Al	47,76	46,55	51,0	21	27	34	8	18	0,105
27 AT5/32-2	32	6F	Al	50,94	49,70	54,0	21	27	38	8	22	0,123
27 AT5/36-2	36	6F	Al	57,31	56,05	63,0	21	27	38	8	22	0,160
27 AT5/40-2	40	6F	Al	63,66	62,45	66,0	21	27	40	8	23	0,193
27 AT5/42-2	42	6F	Al	66,87	65,60	71,0	21	27	40	8	24	0,205
27 AT5/44-0	44	6	Al	70,07	68,80	—	21	27	45	8	26	0,228
27 AT5/48-0	48	6	Al	76,42	75,15	—	21	27	50	8	28	0,280
27 AT5/60-0	60	6	Al	95,52	94,25	—	21	27	65	8	35	0,430

Al = Aluminium

Fertigungstechnische Änderungen vorbehalten. We reserve the right to make technical changes.

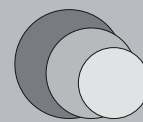

Metrische Zahnscheiben für zylindrische Bohrung Metric timing belt pulleys for plain boring

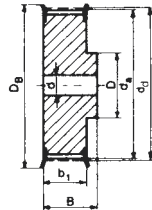

Ausf. Type 6F

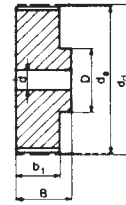

Ausf. Type 6

Type AT5 – Teilung *Pitch* 5 mm für Riemenbreite *for belt width* 25 mm

Bezeichnung Part No.	Anzahl der Zähne No. of teeth	Aus- führung Type	Material	d_d (mm)	d_s (mm)	D_B (mm)	b_1 (mm)	B (mm)	D (mm)	Vor- bohrung Pilot bore d (mm)	Fertig- bohrung Finished bore d_{max} (mm)	Gewicht Weight (\approx kg)
36 AT5/12-2	12	6F	Al	19,01	17,85	23,0	30	36	10	—	6	0,031
36 AT5/14-2	14	6F	Al	22,29	21,05	25,0	30	36	13	—	8	0,037
36 AT5/15-2	15	6F	Al	23,88	22,65	28,0	30	36	16	6	10	0,041
36 AT5/16-2	16	6F	Al	25,47	24,20	32,0	30	36	18	6	11	0,050
36 AT5/18-2	18	6F	Al	28,65	27,40	32,0	30	36	19	6	12	0,061
36 AT5/19-2	19	6F	Al	30,25	29,00	36,0	30	36	22	6	12	0,070
36 AT5/20-2	20	6F	Al	31,83	30,60	36,0	30	36	23	6	14	0,076
36 AT5/22-2	22	6F	Al	35,12	33,85	38,0	30	36	24	6	15	0,080
36 AT5/24-2	24	6F	Al	38,21	37,00	42,0	30	36	26	8	15	0,109
36 AT5/25-2	25	6F	Al	39,80	38,60	44,0	30	36	26	8	15	0,116
36 AT5/26-2	26	6F	Al	41,47	40,20	44,0	30	36	26	8	16	0,120
36 AT5/27-2	27	6F	Al	42,98	41,80	48,0	30	36	30	8	18	0,128
36 AT5/28-2	28	6F	Al	44,62	43,35	48,0	30	36	32	8	18	0,135
36 AT5/30-2	30	6F	Al	47,76	46,55	51,0	30	36	34	8	18	0,150
36 AT5/32-2	32	6F	Al	50,94	49,70	54,0	30	36	38	8	22	0,176
36 AT5/36-2	36	6F	Al	57,31	56,05	63,0	30	36	38	8	22	0,230
36 AT5/40-2	40	6F	Al	63,66	62,45	66,0	30	36	40	8	23	0,276
36 AT5/42-2	42	6F	Al	66,87	65,60	71,0	30	36	40	8	24	0,284
36 AT5/44-0	44	6	Al	70,07	68,80	—	30	36	45	8	26	0,315
36 AT5/48-0	48	6	Al	76,42	75,15	—	30	36	50	8	28	0,400
36 AT5/60-0	60	6	Al	95,52	94,25	—	30	36	65	8	35	0,614



Al = Aluminium

Fertigungstechnische Änderungen vorbehalten. *We reserve the right to make technical changes.*

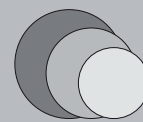

Metrische Zahnscheiben für zylindrische Bohrung Metric timing belt pulleys for plain boring

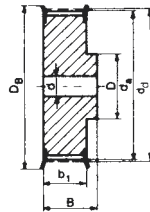

Ausf. Type 6F

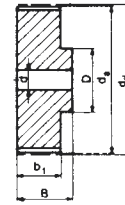

Ausf. Type 6

Type AT10 – Teilung Pitch 10 mm für Riemenbreite for belt width 16 mm

Bezeichnung Part No.	Anzahl der Zähne No. of teeth	Aus- führung Type	Material	d _d (mm)	d _a (mm)	D _B (mm)	b ₁ (mm)	B (mm)	D (mm)	Vor- bohrung Pilot bore d (mm)	Fertig- bohrung Finished bore d _{max} (mm)	Gewicht Weight (≈ kg)
31 AT10/15-2	15	6F	Al	47,75	45,90	51	21	31	32	8	18	0,116
31 AT10/16-2	16	6F	Al	50,93	49,05	54	21	31	35	8	20	0,134
31 AT10/18-2	18	6F	Al	57,29	55,45	60	21	31	40	8	22	0,167
31 AT10/19-2	19	6F	Al	60,48	58,60	66	21	31	44	8	22	0,184
31 AT10/20-2	20	6F	Al	63,66	61,80	66	21	31	46	8	24	0,208
31 AT10/22-2	22	6F	Al	70,03	68,15	75	21	31	52	8	28	0,253
31 AT10/24-2	24	6F	Al	76,39	74,55	83	21	31	58	8	30	0,288
31 AT10/25-2	25	6F	Al	79,58	77,70	83	21	31	60	8	30	0,310
31 AT10/26-2	26	6F	Al	82,76	80,90	87	21	31	60	8	30	0,357
31 AT10/27-2	27	6F	Al	85,95	84,10	91	21	31	60	8	30	0,364
31 AT10/28-2	28	6F	Al	89,13	87,25	93	21	31	60	8	30	0,401
31 AT10/30-2	30	6F	Al	95,49	93,65	97	21	31	60	8	30	0,441
31 AT10/32-2	32	6F	Al	101,86	100,00	106	21	31	65	10	32	0,493
31 AT10/36-2	36	6F	Al	114,59	112,75	119	21	31	70	10	35	0,623
31 AT10/40-2	40	6F	Al	127,32	125,45	131	21	31	80	10	40	0,767
31 AT10/44-0	44	6	Al	140,06	138,20	—	21	31	88	10	46	0,993
31 AT10/48-0	48	6	Al	152,78	150,95	—	21	31	95	16	48	1,090
31 AT10/60-0	60	6	Al	190,98	189,10	—	21	31	110	16	60	1,710

Type AT10 – Teilung Pitch 10 mm für Riemenbreite for belt width 25 mm

40 AT10/15-2	15	6F	Al	47,75	45,90	51	30	40	32	8	18	0,152
40 AT10/16-2	16	6F	Al	50,93	49,05	54	30	40	35	8	20	0,176
40 AT10/18-2	18	6F	Al	57,29	55,45	60	30	40	40	8	22	0,224
40 AT10/19-2	19	6F	Al	60,48	58,60	66	30	40	44	8	22	0,247
40 AT10/20-2	20	6F	Al	63,66	61,80	66	30	40	46	8	24	0,276
40 AT10/22-2	22	6F	Al	70,03	68,15	75	30	40	52	8	28	0,337
40 AT10/24-2	24	6F	Al	76,39	74,55	83	30	40	58	8	30	0,392
40 AT10/25-2	25	6F	Al	79,58	77,70	83	30	40	60	8	30	0,422
40 AT10/26-2	26	6F	Al	82,76	80,90	87	30	40	60	8	30	0,477
40 AT10/27-2	27	6F	Al	85,95	84,10	91	30	40	60	8	30	0,536
40 AT10/28-2	28	6F	Al	89,13	87,25	93	30	40	60	8	30	0,540
40 AT10/30-2	30	6F	Al	95,49	93,65	97	30	40	60	8	30	0,640
40 AT10/32-2	32	6F	Al	101,86	100,00	106	30	40	65	10	32	0,693
40 AT10/36-2	36	6F	Al	114,59	112,75	119	30	40	70	10	35	0,873
40 AT10/40-2	40	6F	Al	127,32	125,45	131	30	40	80	10	40	1,067
40 AT10/44-0	44	6	Al	140,06	138,20	—	30	40	88	10	46	1,350
40 AT10/48-0	48	6	Al	152,78	150,95	—	30	40	95	16	48	1,516
40 AT10/60-0	60	6	Al	190,98	189,10	—	30	40	110	16	60	2,339

Al = Aluminium

Fertigungstechnische Änderungen vorbehalten. We reserve the right to make technical changes.

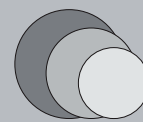

Metrische Zahnscheiben für zylindrische Bohrung Metric timing belt pulleys for plain boring

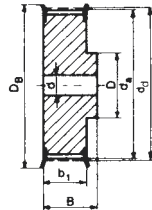

Ausf. Type 6F

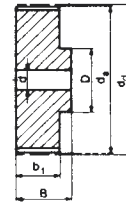

Ausf. Type 6

Type AT10 – Teilung *Pitch* 10 mm für Riemenbreite *for belt width* 32 mm

Bezeichnung Part No.	Anzahl der Zähne No. of teeth	Aus- führung Type	Material	d_d (mm)	d_s (mm)	D_B (mm)	b_1 (mm)	B (mm)	D (mm)	Vor- bohrung Pilot bore d (mm)	Fertig- bohrung Finished bore d_{max} (mm)	Gewicht Weight (≈ kg)
47 AT10/18-2	18	6F	Al	57,29	55,45	60	37	47	40	10	22	0,253
47 AT10/19-2	19	6F	Al	60,48	58,60	66	37	47	44	10	22	0,286
47 AT10/20-2	20	6F	Al	63,66	61,80	66	37	47	46	12	24	0,322
47 AT10/22-2	22	6F	Al	70,03	68,15	75	37	47	52	12	28	0,393
47 AT10/24-2	24	6F	Al	76,39	74,55	83	37	47	58	12	30	0,475
47 AT10/25-2	25	6F	Al	79,58	77,70	83	37	47	60	12	30	0,527
47 AT10/26-2	26	6F	Al	82,76	80,90	87	37	47	60	12	30	0,564
47 AT10/27-2	27	6F	Al	85,95	84,10	91	37	47	60	12	30	0,602
47 AT10/28-2	28	6F	Al	89,13	87,25	93	37	47	60	12	30	0,642
47 AT10/30-2	30	6F	Al	95,49	93,65	97	37	47	60	12	30	0,740
47 AT10/32-2	32	6F	Al	101,86	100,00	106	37	47	65	12	32	0,844
47 AT10/36-2	36	6F	Al	114,59	112,75	119	37	47	70	16	35	1,083
47 AT10/40-2	40	6F	Al	127,32	125,45	131	37	47	80	16	40	1,317
47 AT10/44-0	44	6	Al	140,06	138,20	—	37	47	88	16	46	1,611
47 AT10/48-0	48	6	Al	152,78	150,95	—	37	47	95	16	48	1,931
47 AT10/60-0	60	6	Al	190,98	189,10	—	37	47	110	16	60	3,004

66

Type AT10 – Teilung *Pitch* 10 mm für Riemenbreite *for belt width* 50 mm

66 AT10/18-2	18	6F	Al	57,29	55,45	60	56	66	40	10	22	0,422
66 AT10/19-2	19	6F	Al	60,48	58,60	66	56	66	44	10	22	0,466
66 AT10/20-2	20	6F	Al	63,66	61,80	66	56	66	46	12	24	0,520
66 AT10/22-2	22	6F	Al	70,03	68,15	75	56	66	52	12	28	0,570
66 AT10/24-2	24	6F	Al	76,39	74,55	83	56	66	58	12	30	0,736
66 AT10/25-2	25	6F	Al	79,58	77,70	83	56	66	60	12	30	0,766
66 AT10/26-2	26	6F	Al	82,76	80,90	87	56	66	60	12	30	0,816
66 AT10/27-2	27	6F	Al	85,95	84,10	91	56	66	60	12	30	0,946
66 AT10/28-2	28	6F	Al	89,13	87,25	93	56	66	60	12	30	0,960
66 AT10/30-2	30	6F	Al	95,49	93,65	97	56	66	60	12	30	1,169
66 AT10/32-2	32	6F	Al	101,86	100,00	106	56	66	65	12	32	1,300
66 AT10/36-2	36	6F	Al	114,59	112,75	119	56	66	70	16	35	1,637
66 AT10/40-2	40	6F	Al	127,32	125,45	131	56	66	80	16	40	1,999
66 AT10/44-0	44	6	Al	140,06	138,20	—	56	66	88	16	46	2,357
66 AT10/48-0	48	6	Al	152,78	150,95	—	56	66	95	16	48	2,830
66 AT10/60-0	60	6	Al	190,98	189,10	—	56	66	110	16	60	4,366

Al = Aluminium

Fertigungstechnische Änderungen vorbehalten. We reserve the right to make technical changes.